



Vesttherm

HOT-WATER HEAT PUMP

HIGH QUALITY HOT WATER HEAT PUMPS

MODEL

VT3130 / VT3131 / VT3132

The heat pump exploits the energy of the air to heat the domestic water and is able to cover the annual consumption of an average family. It has a tank capacity of 270 litres and can produce up to approx. 800 litres of hot water per 24 hours. The heat pump is energy saving and makes it possible to save up to 65 percent of the expenses for hot water.

CONSTRUCTION AND EQUIPMENT:

- ✓ D-tube safety condenser precludes pollution of the domestic water with refrigerant and oil – no calcification of the condenser and so constant emission of heat.
- ✓ Heat coil for alternative operation.
- ✓ VT3132 with an extra heat coil for alternative operation e.g. solar heating.
- ✓ With ø160mm duct connections.
- ✓ Adjustable air quantity.
- ✓ 270 Litres, glazed steel tank equipped with a magnesium anode.
- ✓ PUR – hard foam insulation.
- ✓ Thermostatic, continuous variable control, permits an individual energy saving temperature setting.
- ✓ Working pressure 10 bar.



1. Air outlet
2. Evaporator
3. Compressor
4. Air inlet
5. Enamelled tank
6. Sensor pocket
7. Anode (upper)
8. Electrical heating element
9. Sensor pocket
- *10. Anode (lower)
11. Adjustable feet
12. Cold water inlet
13. Safety condenser
14. Insulation
15. Heating coil (lower)
16. Inlet heating coil (lower)
17. Outlet heating coil (lower)
18. Circulation branch
19. Hot water outlet
20. Defrost water outlet
21. Fan
- *22. Heating coil (upper)
- *23. Outlet heating coil (upper)
- *24. Inlet heating coil (upper)

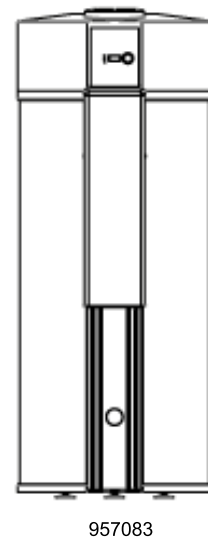
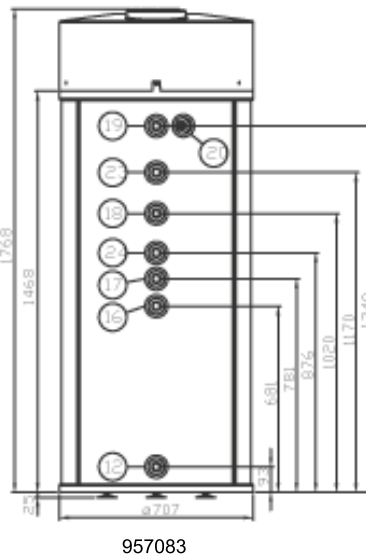
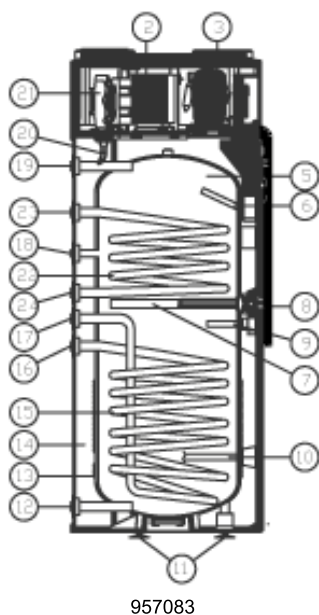

25. Control button push/rotary
26. Control panel (Display)
27. Operating-/alarm lamp heat pump
28. Operating-/alarm lamp supplementary heating



*Only VT3132

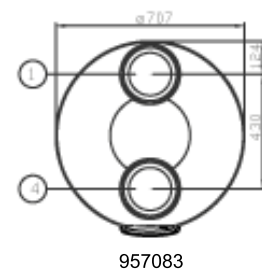

Dimensions:

H x D	mm	1768 x Ø707
Voltage/frequency	Volt/Hz	230/50
Heat pump output	kW	1,85*
Heat pump input	kW	0,55*
Heating element	kW	2,0
Max output	kW	3,85
Water temperature	°C	5-55
Working air temperature VT3131	°C	-10 / +35
Quantity of air	m ³ /h	200/300
Boiler VT3130	L	270
Boiler VT3131	L	258
Boiler VT3132	L	242

Working pressure max	bar	10
Refrigerant R134a	kg	See Nameplate
Heating coil – surface:		
VT3131	m ²	1,00
VT3132	m ²	0,6 + 1,5
Weight empty	kg	130-150-170
Hot and cold heat exchanger	thread	1"
Circulation	thread	3/4"
Defrost water	thread	1/2"
Climate class		SN

Working pressure max
Refrigerant R134a
Heating coil – surface:
VT3131
VT3132
Weight empty
Hot and cold heat exchanger
Circulation
Defrost water
Climate class

bar	10
kg	See Nameplate
m ²	1,00
m ²	0,6 + 1,5
kg	130-150-170
thread	1"
thread	3/4"
thread	1/2"
	SN

* At an temperature of +20°C - 70% RH and heating of the water from 15°C to 47°C.

Installation:

The heat pump is compact delivered, ready assembled with wire for connection to a socket. The hot- and cold water pipes are connected to the heat pump according to the present rules (safety

group is not included). An outlet for the melt water is provided. The tank is filled with water and the heat pump is then ready for use.



Vesttherm A/S
Høgevej 9
DK-6705 Esbjerg Ø
Denmark
Phone +45 7514 0244
Fax +45 7514 4818

www.vesttherm.com